

**THE CORPORATION
OF THE
TOWNSHIP OF WELLESLEY**

BY-LAW NUMBER 23/2009

**A BY-LAW TO AMEND BY-LAW NUMBER 28/2006, AS AMENDED, BEING A
ZONING BY-LAW FOR THE TOWNSHIP OF WELLESLEY**

(ELMARCO DEVELOPMENTS)
Part Lot 2, Concession 7, Eastern Section

WHEREAS the Council of the Corporation of the Township of Wellesley deems it desirable to further amend said By-law Number 28/2006.

AND WHEREAS notice of intent to remove the holding symbol has been given pursuant to the provision of Section 36 of the Planning Act

NOW THEREFORE, the Council of the Township of Wellesley ENACTS AS FOLLOWS:

1. That the "h2" holding symbol attached to the DI (h2) Zone be and is hereby removed,
2. This By-law shall come into effect on the final passing thereof by the Council of the Corporation of the Township of Wellesley subject to compliance with the provisions of the Planning Act, RSO 1990.

Read a first and second time this 4th day of May, 2009.

Read a third and final time and passed this 4th day of May, 2009.

Ross Kelterborn
Mayor Ross Kelterborn

Susan Duke
CAO/Clerk, Susan Duke

SCHEDULE 'A'

LEGAL DESCRIPTION

The following is the legal description of the parcel subject to this b-law

Part Lot 2, Concession 7. Eastern Section; St. Clements, in the Township of Wellesley, Region of Waterloo.

SCHEDULE 'B'

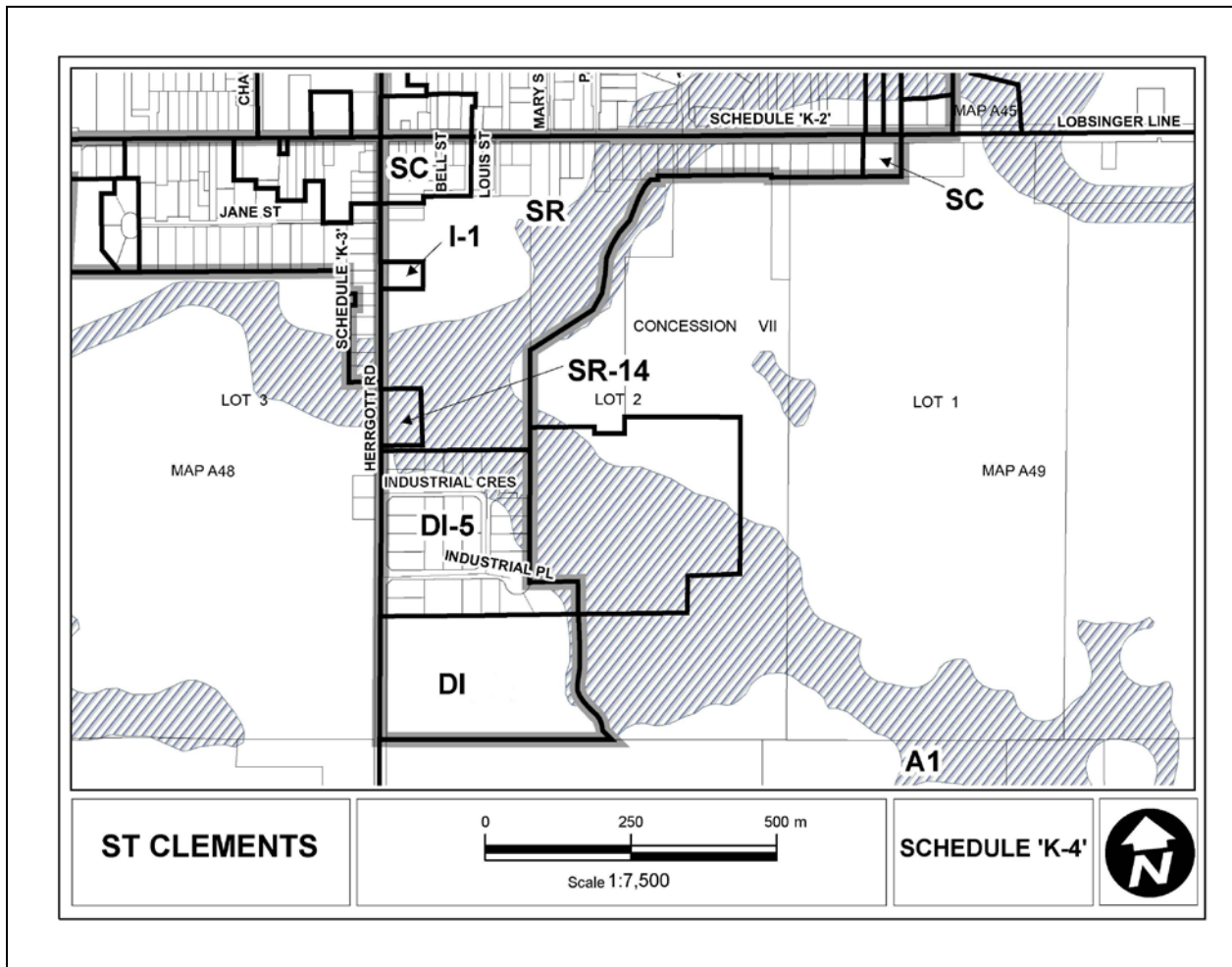

Read a first and second time this 4th day of May, 2009.

Read a third and final time and passed this 4th day of May, 2009.

Mayor Ross Kelterborn

CAO/Clerk, Susan Duke