

**THE CORPORATION OF THE TOWNSHIP OF WELLESLEY**

**BY-LAW NUMBER 16/2009**

**A BY-LAW TO AMEND BY-LAW NUMBER 28/2006, AS AMENDED, BEING A ZONING  
BY-LAW FOR THE TOWNSHIP OF WELLESLEY**

(BAUMAN)  
3024 030 004 00703

WHEREAS the Council of the Corporation of the Township of Wellesley deems it desirable to further amend said By-law Number 28/2006.

NOW THEREFORE, the Council of the Township of Wellesley ENACTS AS FOLLOWS:

1. That By-law Number 28/2006, as amended, is hereby further amended by deleting the existing Section 5.10.77 and inserting a replacement Section 5.10.77 as follows:

“5.10.77      Defined Area

A1-77 as shown in Schedule ‘A’, Map 39 to this By-law

Permitted Uses

One residential building - 1 unit which may include a private home day care, or a home occupation, or office;  
Farming, except sod farming or the keeping or raising of livestock for commercial purposes;  
Manufacturing of log splitters;  
Manufacturing of rivets, bolts, drinker stems (A 3/93)

Maximum Floor Area

589.25 m<sup>2</sup> (6,000 ft<sup>2</sup>)

Minimum Lot Area

4,249 m<sup>2</sup> (45,736 ft<sup>2</sup>)

Minimum Lot Frontage.

60 metres (197 feet)

Minimum Rear Yard

2.4 m (8 feet)

Maximum Lot Coverage

15%”

2. That the subject lands as shown on Schedule ‘A’ to this By-law shall be subject to all other applicable regulations of By-law 28/2006, as amended.
3. This By-law shall come into effect on the final passing thereof by the Council of the Corporation of the Township of Wellesley subject to compliance with the provisions of the Planning Act, RSO 1990.

Read a first and second time this 17th day of March, 2009.

Read a third and final time and passed this 17th day of March, 2009.

**Ross Kelterborn**  
Mayor Ross Kelterborn

**Susan Duke**  
CAO/Clerk, Susan Duke

SCHEDULE 'A'  
To By-law 16/2009

LEGAL DESCRIPTION

The following is the legal description of the parcel subject to this by-law

Part Lot 6, Concession 11, Eastern Section; R.R.#1 St. Clements, in the Township of Wellesley,  
Region of Waterloo.

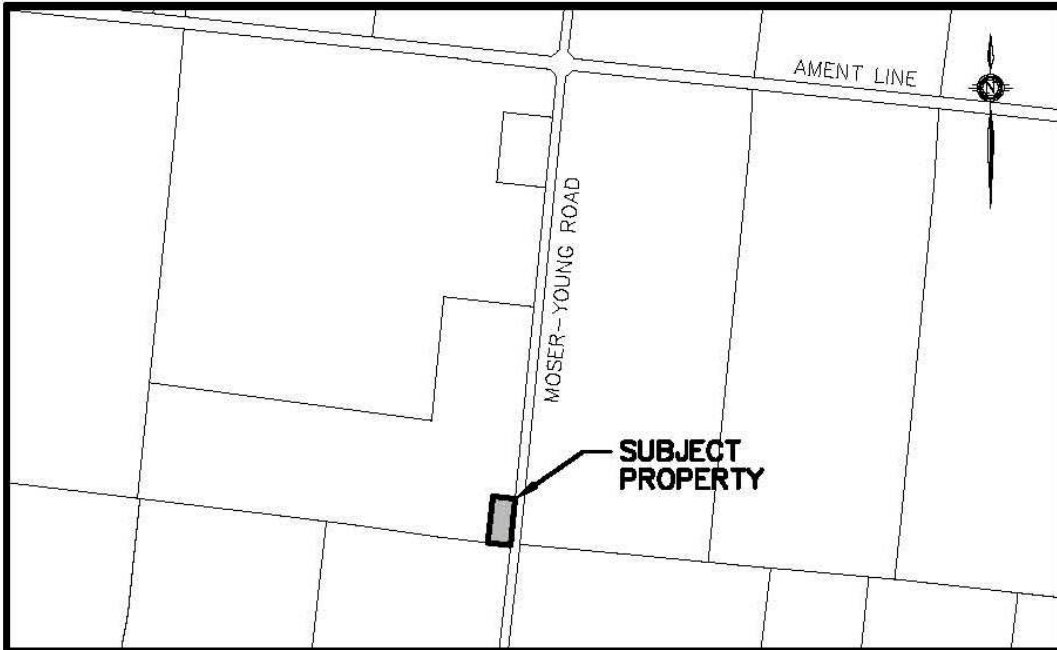

*Scale: N.T.S.*