

**THE CORPORATION OF THE TOWNSHIP OF WELLESLEY**

**BY-LAW NUMBER 10/2008**

**A BY-LAW TO DESIGNATE A SITE PLAN CONTROL AREA  
(Leis Pet Distributing, 2047722 Ontario Inc.)**

Whereas the Council of the Township of Wellesley deems it desirable to designate a Site Plan Control Area, pursuant to Section 41 of The Planning Act, R.S.O. 1990, Ch 13.

**NOW THEREFORE THE COUNCIL OF THE TOWNSHIP OF WELLESLEY ENACTS AS FOLLOWS:**

1. That the lands shown on the Plan forming Schedule "A" to this By-law be and the same are hereby designated as a Site Plan Control Area pursuant to the provisions of Section 41 of the Planning Act, R.S.O. 1990.
2. This By-law shall come into effect on the final passing thereof by the Corporation of the Township of Wellesley.

Read a first and second time this **19<sup>th</sup>** day of **February, 2008**

Read a third and final time and passed this **19<sup>th</sup>** day of **February, 2008**

**Ross Kelterborn**  
Mayor, Ross Kelterborn

**Susan Duke**  
Clerk, Susan Duke

**THE CORPORATION OF THE TOWNSHIP OF WELLESLEY**  
**SCHEDULE 'A'**  
of  
**BY-LAW NUMBER 10/2008**

**A BY-LAW TO DESIGNATE A SITE PLAN CONTROL AREA**

Section East, Con 1, Part Lot 14, RP; 58R14850 Parts 1 and 2  
1315 Hutchinson Road  
(Roll # 3024 020 008 01707)

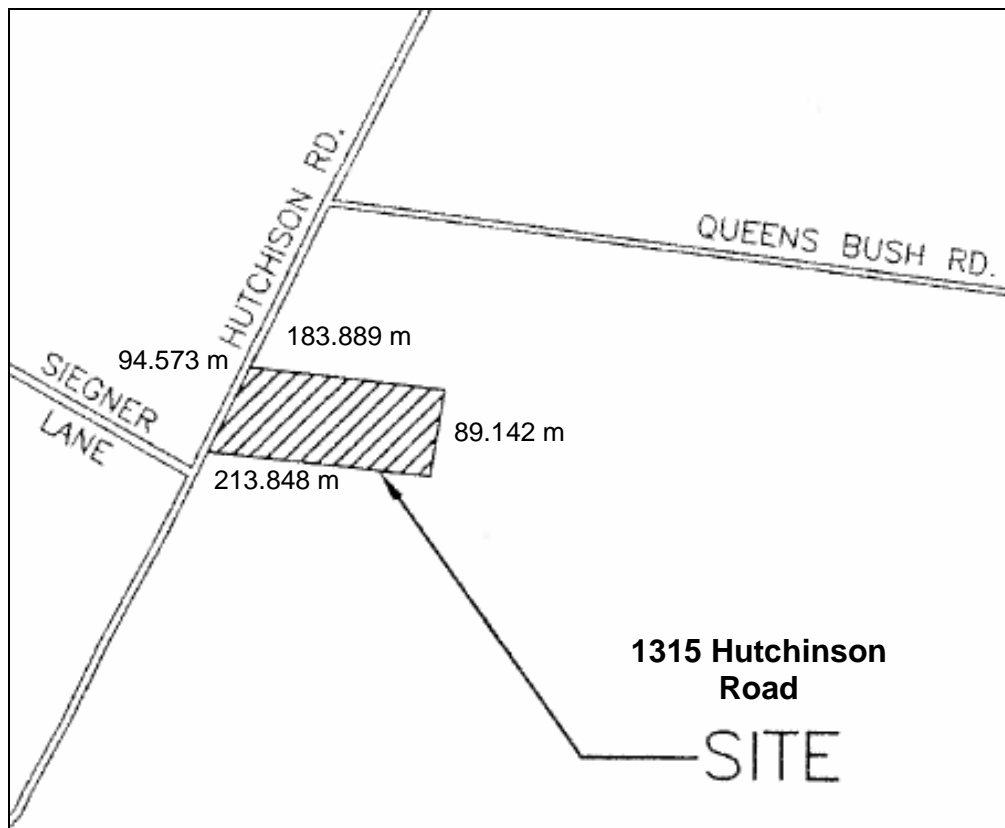

**THIS IS SCHEDULE "A" TO BY-LAW NUMBER 10/2008 PASSED THIS 19th DAY OF FEBRUARY, 2008.**

**Ross Kelterborn**  
Mayor, Ross Kelterborn

**Susan Duke**  
Clerk, Susan Duke